

EN INSULATOR SERIES



Product Features

Operating Temperature: $-40^{\circ}\text{C} \sim +140^{\circ}\text{C}$
screw nut: Brass. Steel with Zn coating
Material: BMC (Bough Moulding Compound)
SMC (Sheet Moulding Compound)
Color, Nut, material In capability accordance with customer needs
Installation Screw (Accessory Option)

EN Insulator Series



Product Model and Meanings



Product Features:

Operating Temperature: -40°C ~ +140°C
 screw nut: Brass. Steel with Zn coating
 Material: BMC (Bough Moulding Compound)
 SMC (Sheet Moulding Compound)
 Color, Nut, material In capability accordance with customer needs
 Installation Screw (Accessory Option)

EN-26*25

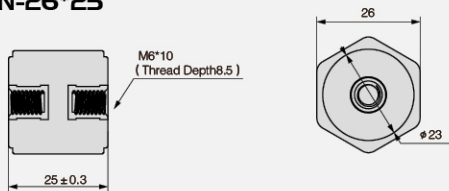

Voltage withstand(KV)	8
Torgue strength (N/m)	12
Thread (mm)	6/8
Thread Depth (mm)	8.5

EN-26*30

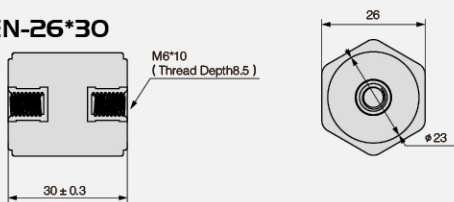

Voltage withstand(KV)	8
Torgue strength (N/m)	12
Thread (mm)	6/8
Thread Depth (mm)	8.5

EN-26*40

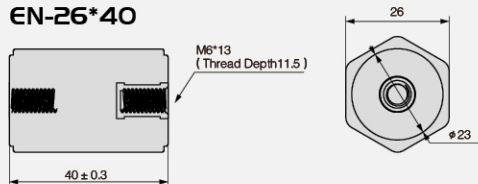

Voltage withstand(KV)	10
Torgue strength (N/m)	12
Thread (mm)	6/8
Thread Depth (mm)	11.5

EN-26*50

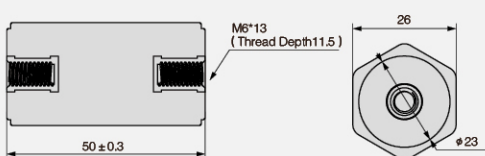

Voltage withstand(KV)	10
Torgue strength (N/m)	12
Thread (mm)	6/8
Thread Depth (mm)	11.5

EN-26*60

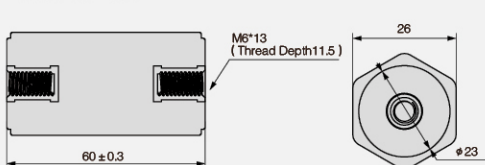

Voltage withstand(KV)	10
Torgue strength (N/m)	12
Thread (mm)	6/8
Thread Depth (mm)	11.5

SE/GB INSULATOR SERIES



Product Features

Operating Temperature: $-40^{\circ}\text{C} \sim +140^{\circ}\text{C}$
screw nut: Brass. Steel with Zn coating
Material: BMC (Bough Moulding Compound)
SMC (Sheet Moulding Compound)
Color, Nut, material In capability accordance with customer needs
Installation Screw (Accessory Option)

SE Insulator Series



Product Model and Meanings

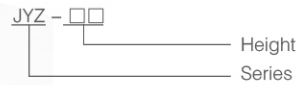

Product Features:

Operating Temperature: -40°C ~ +140°C
 screw nut: Brass. Steel with Zn coating
 Material: BMC (Bough Moulding Compound)
 SMC (Sheet Moulding Compound)
 Color, Nut, material In capability accordance with customer needs
 Installation Screw: Option

SEΦ20*20 Insulator

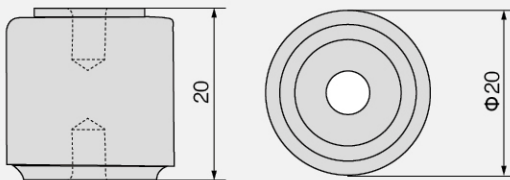

Tensile strength (LBS)	200
Voltage withstand(KV)	5
Torgue strength (N/m)	8
Thread (mm)	5
Thread Depth (mm)	7

SEΦ30*30 Insulator

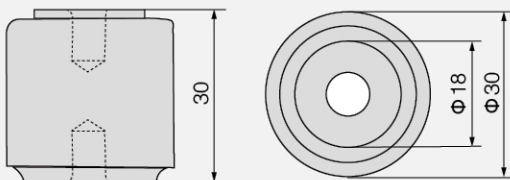

Tensile strength (LBS)	650
Voltage withstand(KV)	10
Torgue strength (N/m)	12
Thread (mm)	6
Thread Depth (mm)	10

SEΦ30*40 Insulator

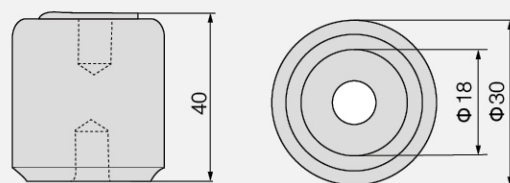

Tensile strength (LBS)	650
Voltage withstand(KV)	10
Torgue strength (N/m)	12
Thread (mm)	6
Thread Depth (mm)	10

SE Insulator Series

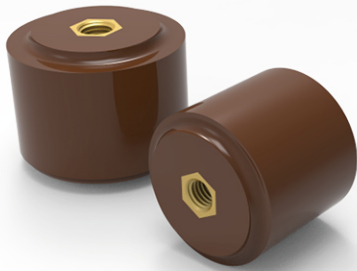

Product Model and Meanings



Product Features:

Operating Temperature: -40°C ~ +140°C
 screw nut: Brass. Steel with Zn coating
 Material: BMC (Bough Moulding Compound)
 SMC (Sheet Moulding Compound)
 Color, Nut, material In capability accordance with customer needs
 Installation Screw (Accessory Option)

SEΦ40*40 Insulator

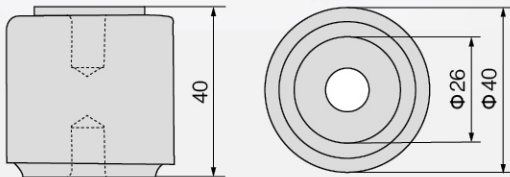

Tensile strength (LBS)	650
Voltage withstand(KV)	10
Torgue strength (N/m)	12
Thread (mm)	8
Thread Depth (mm)	13

SEΦ50*40 Insulator

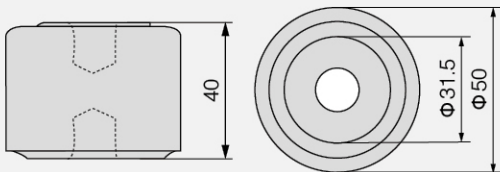

Tensile strength (LBS)	1000
Voltage withstand(KV)	10
Torgue strength (N/m)	20
Thread (mm)	10
Thread Depth (mm)	13

SEΦ60*60 Insulator

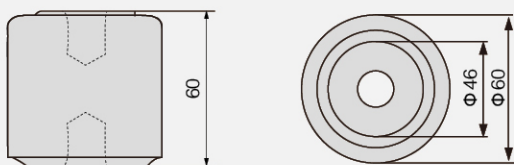

Tensile strength (LBS)	1000
Voltage withstand(KV)	10
Torgue strength (N/m)	20
Thread (mm)	12
Thread Depth (mm)	14

